

IMPACT-RESISTANCE TESTS SKYPORT



grande forge

DESCRIPTION OF THE TESTED ITEM (TECHNICAL DRAWING BELOW) :

GLAZING : shatterproof glass 44.2 - Thickness 8 mm - Dimensions : 772 x 892 mm

FRAMEWORK : Stainless Steel tube 60.3 x 3.6 AISI 316L for the post and the handrail,
Stainless Steel tube 42.4 AISI 316L for the lower cross rail.
A, B and C ensure the connection of the pieces that make up the frame.

MAINTAINING OF THE GLAZING : two patterns representing the clips that hold the glazing (D & E).

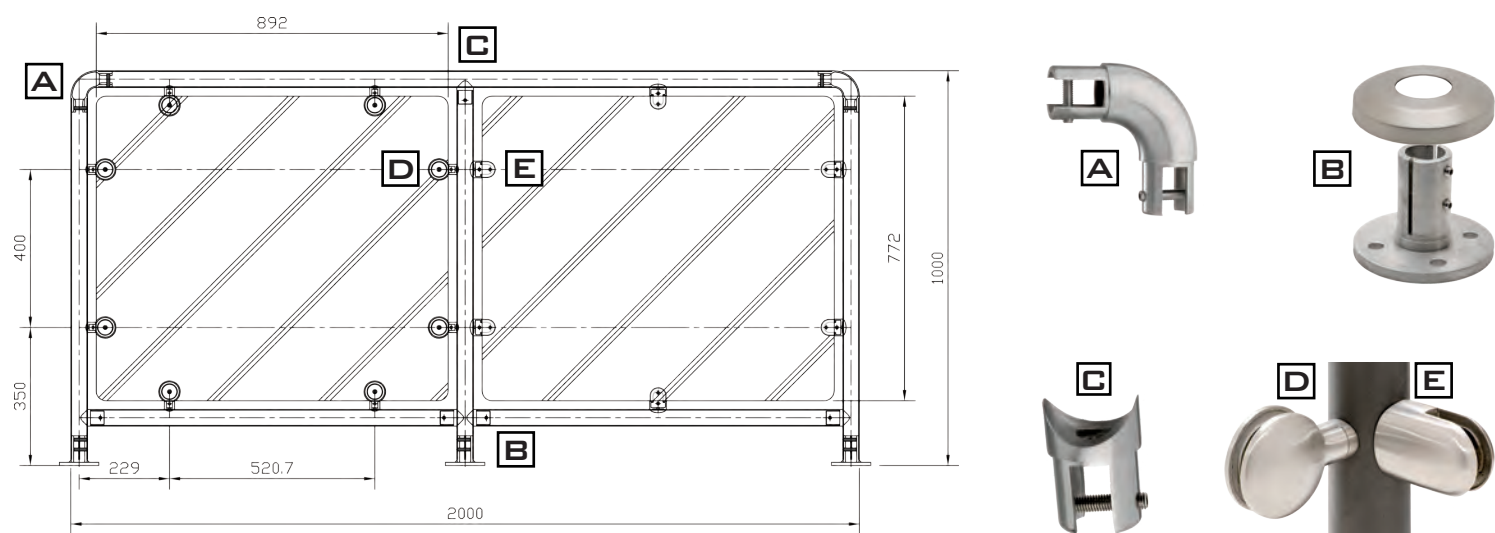

RESISTANCE TO DEFORMATION TESTS

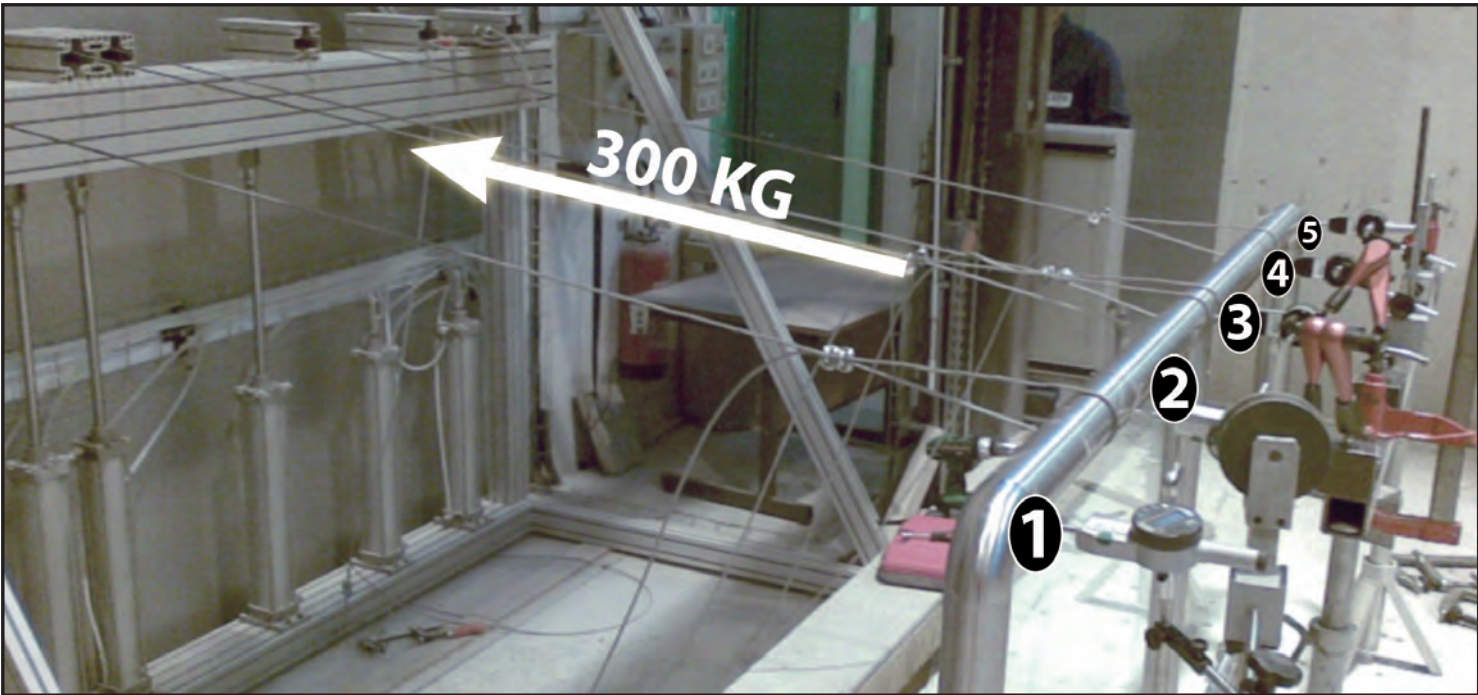

CRITERIA	MEASURES (MM)					RESULT
	1	2	3	4	5	
THE ACCEPTABLE RESIDUAL DISTORTION MUST NOT EXCEED 8MM.	0,89	0,68	0,68	0,55	0,41	ACCEPTABLE

IMPACT-RESISTANCE TESTS

AIM OF THE TESTS : to assess the impact-resistance of a railing according to the norm NF P 08 302 to define the performance of impact-resistance of the tested railing.

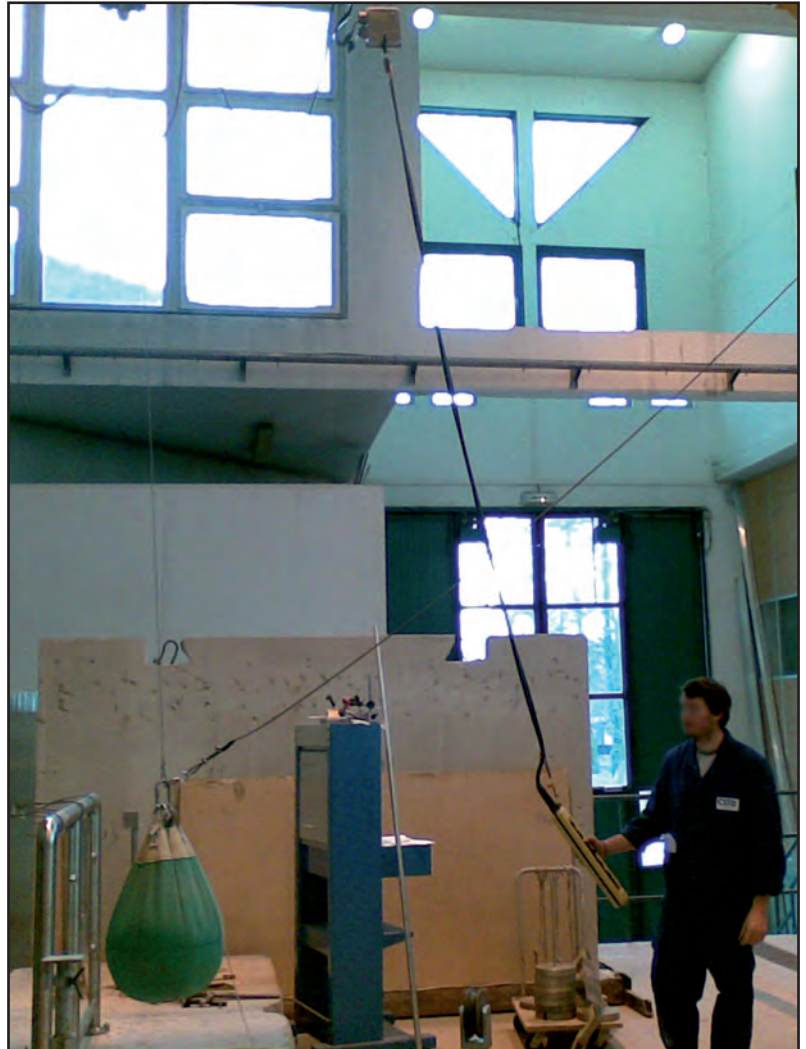
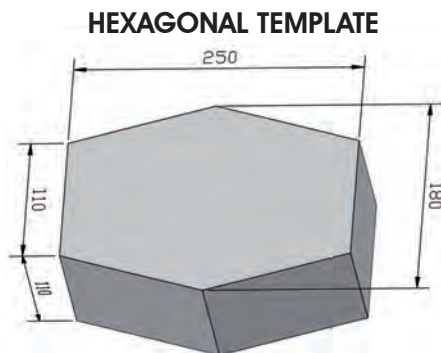
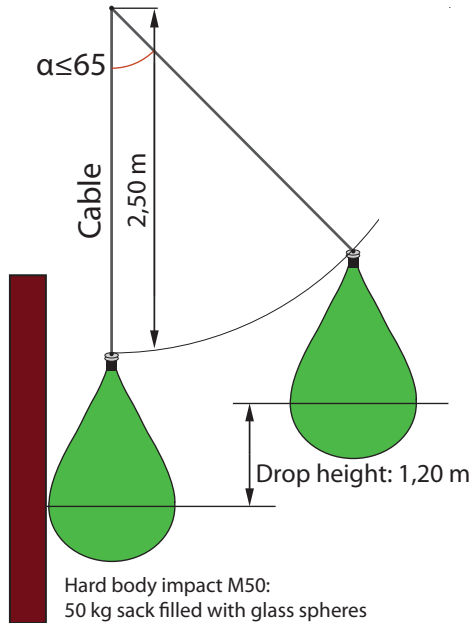

SPECIFICATIONS	TEST RESULTS
FRAGMENTS TO BE CONFINED.	ACCEPTABLE
THE HEXAGONAL TEMPLATE MUST NEITHER GET THROUGH THE HANDRAIL NOR THE LOWER CROSS RAIL.	ACCEPTABLE
THE HEXAGONAL TEMPLATE MUST NOT PASS THROUGH THE BROKEN GLAZING.	ACCEPTABLE
THE GLAZING MUST NOT COME OFF ITS FASTENINGS.	ACCEPTABLE

CSTB



Route Départementale 468
67 114 ESCHAU FRANCE
Tél.(33) 03 88 64 09 98
Fax.(33) 03 69 55 70 94
info@grande-forge.tm.fr
www.grande-forge.com



grande forge